

installation instructions

list of accessories

A

4x

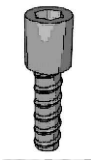

B

2x



C-1

M10 x 120mm (nylon wall plug with Zinc plated screw) suitable for concrete or masonry wall openings.

6x



C-2

M8 x 100mm P/ck MTS (Pozi countersunk Machine screws) suitable for metallic, steelwork wall fixtures.

6x



D-1

4x



D-2

4x



E

32x



F

2x



Side Frame
Symmetric components

G

1x



Top Frame

H

1x



Bottom Frame
(threshold)

J

2x



Border clip plate

X

1x



Active Slab

Y

1x

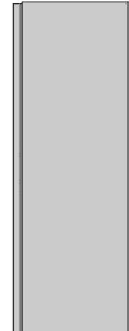

Inactive Slab

TOOLS (not provided)



6mm Allen Wrench



12mm Allen Wrench

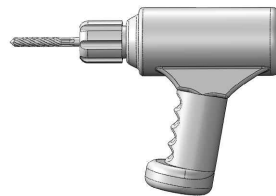

1

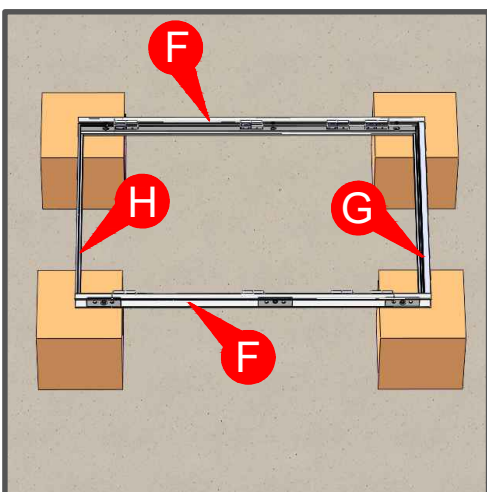

1. Place the frame on the floor or a flat surface.
(Please inspect all parts and contact us immediately for replacements if needed.)

2

Repeat it for both sides.

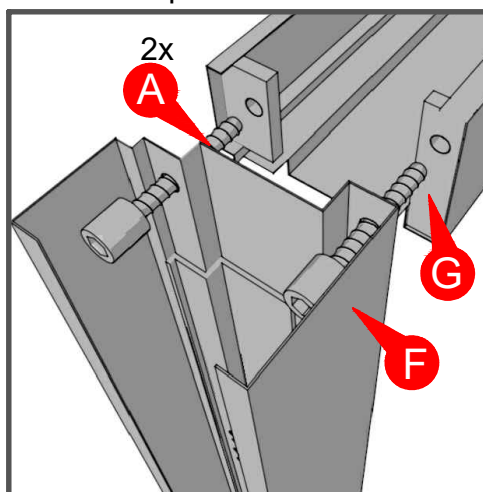

2. Connecting the side frame (F) and the upper frame (G) by 2 pcs bolts (A). (6mm allen key)

3

Repeat it for both sides.

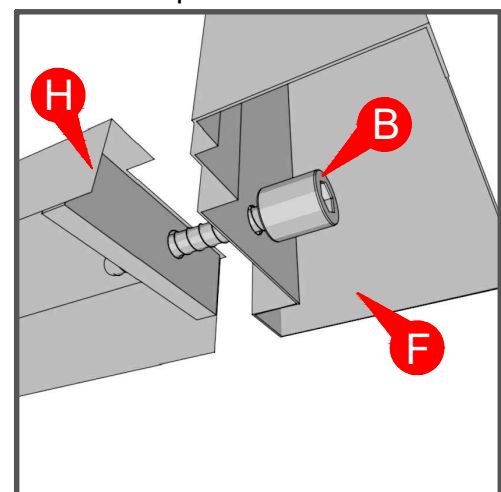

3. Connecting the side frame (F) and the bottom threshold frame (H) by 2 pcs short bolts (B). (6mm allen key)

4

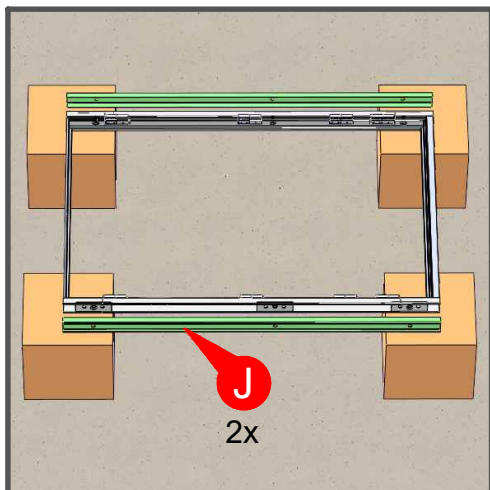

4. Install the border clamps on both sides, making sure the holes are aligned.

5

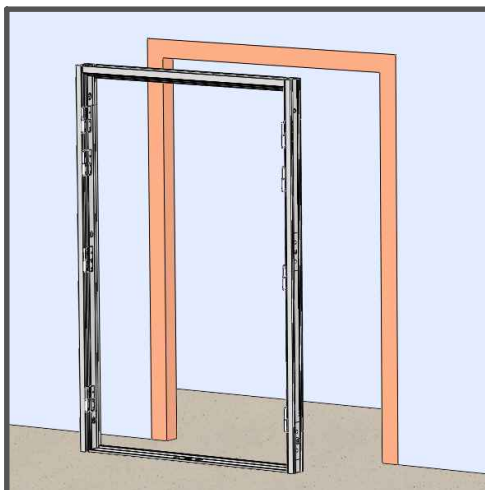

5. Install the frame to the wall opening space.

6

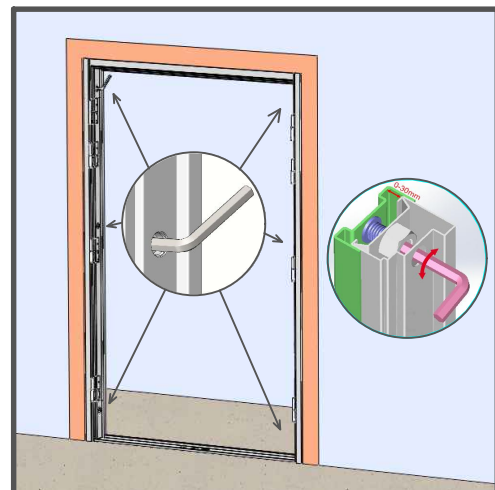

6. Adjust the frame to fit the wall opening properly by tightening the 6 anchors (attached to the frame) with a 12mm Allen Wrench (not provided). Warning: do not over tighten the anchors.

7

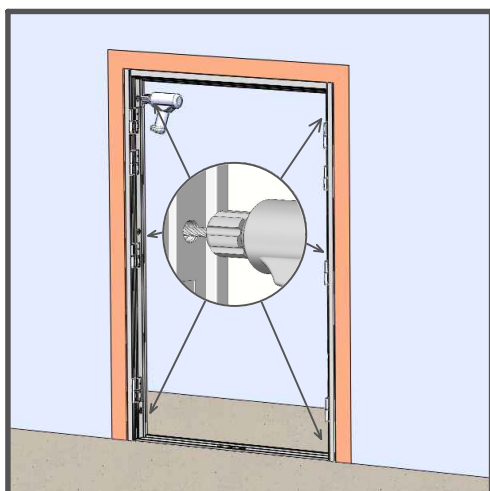

7. Drill a hole in the wall through the center of the hexagonal adjustable bolt to install the fixing screw. (If using our accessory C, handheld electric drill and 10mm drill bit are required for drilling)

8

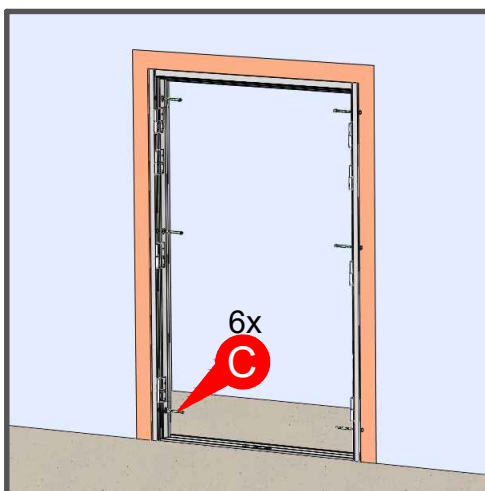

8. Choose a proper wall-screws (C) based on your wall material type: C-1 or C-2. Place your chosen 6pcs wall-screws to each anchor and tighten them as shown in image.

Recommend: For walls made of other materials, please purchase and install screws by yourself

9

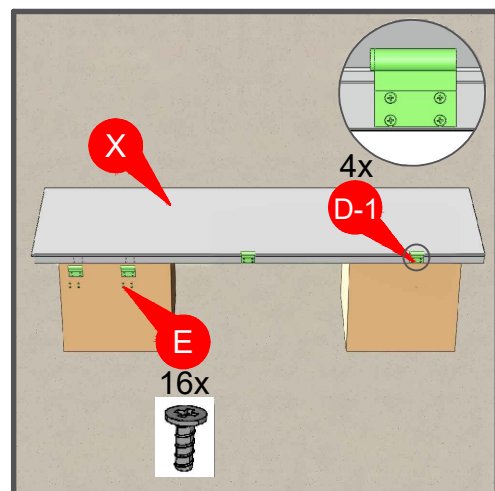

9. Install the hinge plates (D1x4pcs) onto the Active Slab (X) with screws (E x16pcs).

10

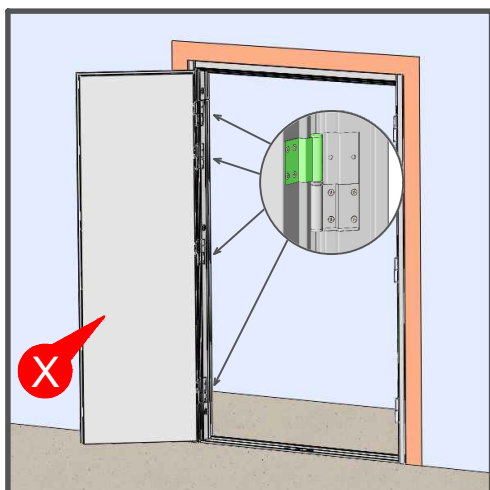

10. Install the Active Slab (X) onto the frame with both hinge plates lined up properly. Test the door slab by opening and closing to make sure it works.

11

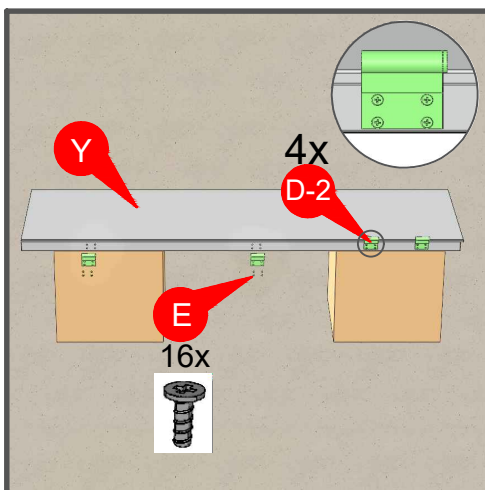

11. Install the hinge plates (D2x4pcs) onto the Inactive Slab (Y) with screws (E x16pcs).

12

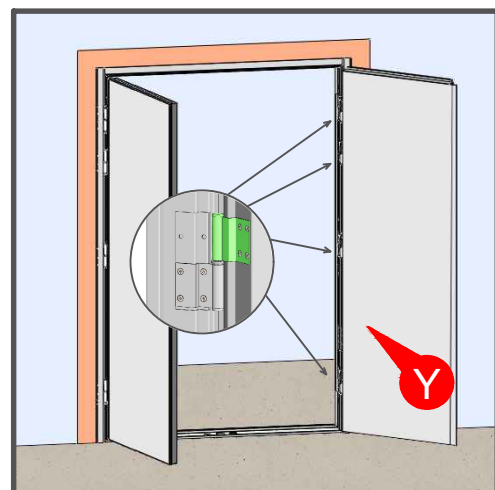

12. Install the Inactive Slab (Y) onto the frame with both hinge plates lined up properly. Test the door slab by opening and closing to make sure it works.